

Commercial Lighting Industries  
81161 Indo Boulevard, Indio, CA 92201  
Tel: 800-755-0155 | Fax: 760-262-5940

No.	Issue	Date
1	DRAWING ISSUE	09.20.21
2	REVISION ISSUE	09.23.21
3	REVISION ISSUE	09.27.21
4	REVISION ISSUE	12.01.21

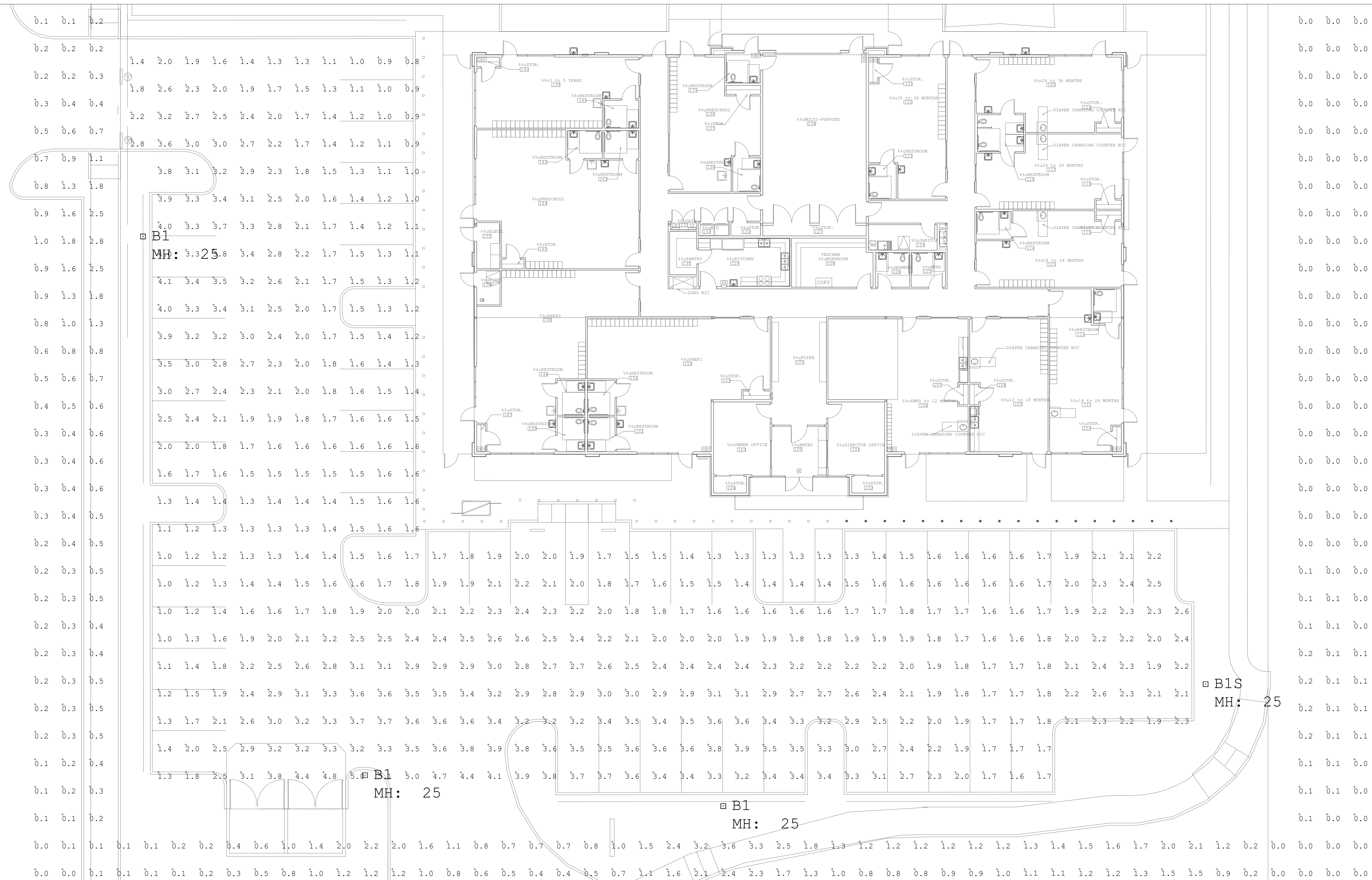

GODDARD SCHOOL - ROSEVILLE  
MAINTAINED HORIZONTAL ILLUMINANCE CALCULATIONS AT FINISH GRADE  
REVISED 12-1-21

Luminaire Schedule						
Symbol	Qty	Label	Description	LLF	Luminaire Lumens	Luminaire Watts
□	3	B1	LED AREA LIGHT TYPE IV DIST	0.950	21725	166
□	1	B1S	LED AREA LIGHT TYPE IV DIST W HSS	0.950	15334	166

Calculation Summary								
Label	CalcType	Units	Avg	Max	Min	Avg/Min	Max/Min	
Light Trespass	Illuminance	Fc	0.34	3.6	0.0	N.A.	N.A.	
Parking	Illuminance	Fc	2.22	5.1	0.8	2.78	6.38	

GODDARD SCHOOL  
ROSEVILLE

LIGHTING  
PLAN &  
PHOTOMETRIC  
LAYOUT

Scale: 3/32"=1'-0" Date: 12.01.21  
Drawn By: FG Checked By: I.D.  
Sheet No.: